

PRODUCT : STEEL FIBRE BT-HE 75/50

Used:

- Used in concrete constructions as a structural reinforcement.

Dimensions:

- fibre diameter d: 0,75 mm
- area of the cross section of the fibre A: 0.4418 mm²
- fibre length L: 50 mm
- aspect ratio $\lambda=l/d$: 67
- hook length x : 1 - 4 mm
- hook depth H: 1.8 mm
- bending angle α : 45° (min. 30°)
- torsion angle: < 30°
- curvature of the fibre: max. 5% of length L
- number of fibres per kg: 5600

Material characteristics:

- tensile strength R_m: 1200 N/mm²
- density of the steel ρ : 7,8 g/mm³
- modulus of elasticity E: 200 – 220 GPa

Confirmity of the product:

- system of attestation of conformity (EN 14889-1:2006): system 1
- min. values of residual flexural strength of SFRC (EN 14889-1:2006)
- 1,5 MPa 0,5mm CMOD (central deflection of the beam 0,47mm)
- 1,0 MPa 3,5mm CMOD (central deflection of the beam 3,02mm)

Packaging:

- cardboard boxes
- weight of the box: 25/20 kg
- boxes on EUR pallet: 48/40 boxes
- neto weight of the pallet: 1200/1000 kg
- pallets are wrapped or welded into plastic folio

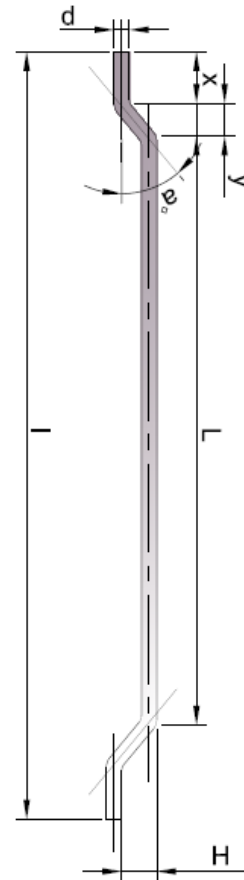

Betotrade OÜ

Tapri 13
Tallinn, 11415, Estonia, EU
Tel : +372 6 56 67 67
E-mail : info@betotrade.ee
www.betotrade.ee